

Access Guide

Transportation to Sapporo Convention Center

Sapporo Convention Center is located approximately 10 min. by taxi from Sapporo city center.

Also, Sapporo's highly developed public transportation system provides easy access to all the visitors

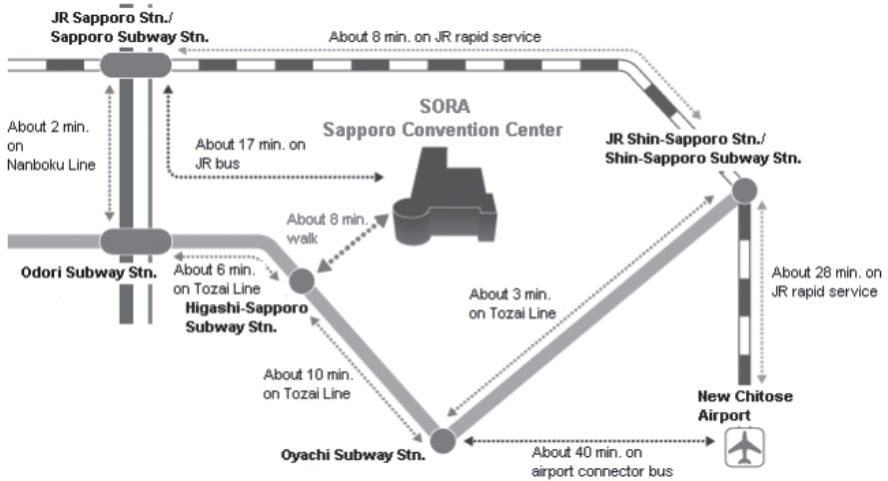

Domestic access to Sapporo



The required time from the main domestic airport

- ▶ Tokyo International Aiport (Haneda)
About 1 hour 30 minutes
- ▶ Narita International Aiport
About 1 hour 45 minutes
- ▶ Kansai International Aiport
About 2 hour 00 minutes
- ▶ Chubu Centrair International Aiport
About 1 hour 35 minutes
- ▶ Fukuoka Aiport
About 2 hour 15 minutes
- ▶ Naha Aiport
About 3 hour 05 minutes

Sapporo is very accessible for convention participants as several international and domestic air routes are directly connected to New Chitose Airport.

Connecting flights via Tokyo, Osaka, and Nagoya within the same day to Sapporo are available for many major international flights.

Venue Map

[Sapporo Convention Center]

1F

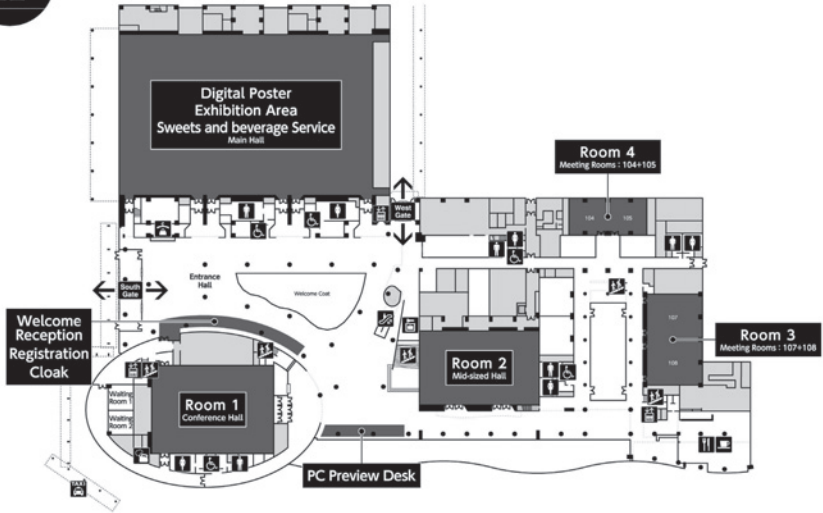

2F

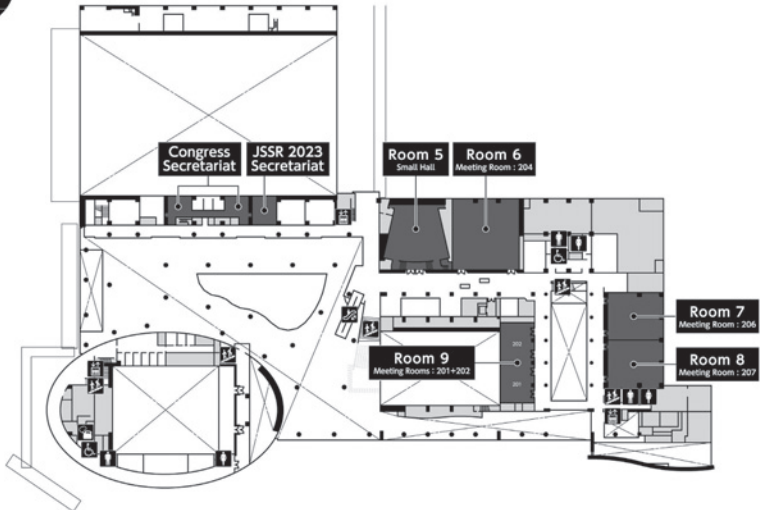

[Sapporo Business Innovation Center]

1F

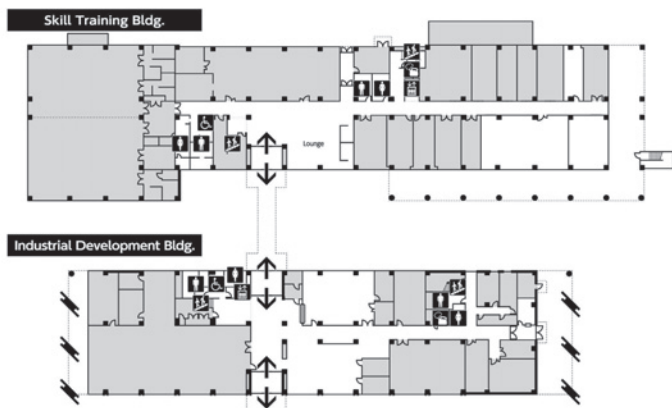

2F



3F

